

# Billingham Sports Hub

## Public Consultation Material



# Introduction

The Billingham Sports Hub proposal is being progressed via the Football Foundations Hubs Programme which is designed to create financially sustainable grassroots sports facilities with multiple artificial grass pitches. The programme is targeted at local authorities and whilst the Football Foundation's investment is football-led, Hubs will support the delivery of a wide range of other sports, activities and programmes.

There's no one-size fits all to the facility mix of a Hub it its design is tailored to local circumstances and identified needs. The proposals which have been developed for consultation have been shaped by engagement with leagues, clubs, local organisations, key stakeholders and national governing bodies for various sports. A key focus has been how the proposals can provide a balanced programme of use that supports the objective of tackling inequalities.

## ***When is the consultation period and how can I comment?***

The consultation will run from **Monday 3rd June until Friday 28th June 2024**. During this period, you can view and provide comments of the proposals both online using the links below:

[www.stockton.gov.uk/billinghamsportshub](http://www.stockton.gov.uk/billinghamsportshub)

During the consultation period we will also be:

- Making copies of documents and response forms available within Billingham Library and Customer Service Centre during normal opening hours (see <https://stockton.gov.uk/find-library>); and
- Holding a public drop-in session between 5:30pm and 7:30pm on Wednesday 19th June 2024 at BEDE Sports Centre, Marsh House Ave, Stockton-on-Tees, Billingham TS23 3HB

## ***Local Community Organisations & Sports Clubs?***

We are keen to hear from community groups and sports organisations who are interested in using the proposed facilities. No matter how big or small the organisation is, we want to understand how you might want to access the facility and how it can help meet local needs.

We want to ensure the facility provides a balanced programme of use and supports the objective of tackling inequalities. Usage does not necessarily have to be sporting focused as the facility includes a community room which could be used for a variety of uses throughout the week.

If you are a local club or organisation who would be interested in using facilities within the proposal, please contact [placedevelopment@stockton.gov.uk](mailto:placedevelopment@stockton.gov.uk) so we can discuss the facility and opportunities further with you.



# Site Constraints and Opportunities

## Key Constraints

- A large statutory sewer and culverted watercourse which run west to east along the right-hand boundary. These assets require an easement zone which restricts development in their immediate area.
- Areas within flood risk zones 2 & 3. Any development within these areas will need to be flood risk assessed and mitigation may be required.
- There are three residential boundaries to the site (alongside other adjacent land uses). Any adverse impacts from noise and lighting need to be assessed and adequately mitigated.
- Marsh House Avenue provides vehicular access to the site. Consideration will be required to ensure junctions can accommodate traffic movements satisfactorily and whether any mitigation is required.
- Bede Sixth Form College is an operational educational facility and students safeguarding need to be considered through the design, construction and operation of the proposal.

## Key Opportunities

- Shared usage with Bede Sixth Form College including site access, car parking and changing/sports facilities
- Site security and issues of antisocial behaviour can also be improved. The site currently has unrestricted access to the playing fields and there are opportunities to control and manage access whilst maintaining public accessibility. CCTV could also be explored.
- The existing playing fields include large areas of hardstanding left over from the previous secondary school and there is an opportunity to resurface these with grass to increase the site's playing field quantum.





# Design Concept: Masterplan

The facilities within the proposed Hub have been identified based on identified needs and in consultation with governing bodies for sports, local leagues and clubs and other stakeholders. Facilities briefly comprise:

- Pavilion building for the Sports Hub, including reception, café, and change, attached to the existing Bede Sports Centre
- 2 full size community Artificial Grass Pitches (AGPs)
- Community AGP replacing existing Bede Sixth Form College AGP. This will be designed to National League System (NLS) grade 6 standards (adaptable to grade 4) with stands and other associated elements.
- 3 5v5 community AGPs
- Athletics enclosure, including 200m mini-track, 110m sprint straight, jump straight, and facilities for other athletic events
- Active Track (approx. 1km loop) with grass pitch plateau within
- Minor remodelling to existing Bede Sports Centre to provide National League System changing rooms
- New car park (circa. 225 bays)

The masterplan concept is driven by the operational requirements of the various end users. The new pavilion building is the central hub for the venue, wrapping around the existing sports centre with good visibility from Marsh House Avenue.

Further details on how facilities are accessed is provided overleaf within the 'Site Access Strategy'





# Site Access Strategy

The new pavilion building is the central hub for the venue, wrapping around the existing sports centre. This provides the main entrance to access formal sports provision (AGPs and formal athletics enclosure).

Football pitches are placed at the forefront, with the community AGPs closest to the new pavilion building and the NLS pitch accessed directly from the NLS changing facilities which would be located within the existing Bede Sports Centre.

The formal athletics enclosure makes use of the q-shaped area to the left of the pitches and can be accessed via the hub (with opportunity to access directly from the car park when required). The athletics enclosure also has direct access out on to the active track which will be controlled by clubs during sessions.

The publicly accessible area containing the active track and grass pitches will benefit from boundary treatment protecting and controlling access and egress points.

Primary access to the active track for those not wishing to access via the pavilion will be from Neasham Avenue.

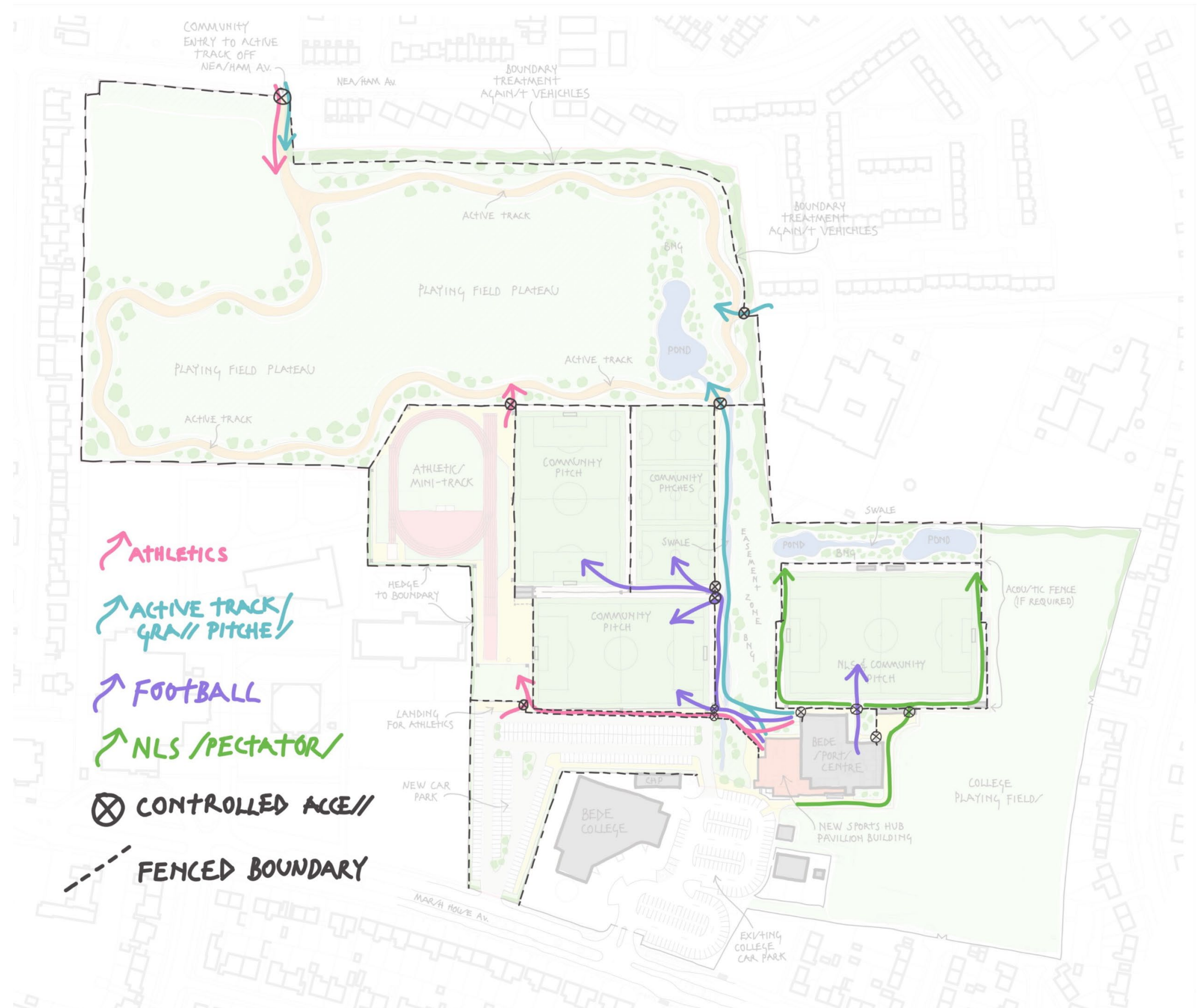



# Design Concept: Pavilion Building

## Materials & Appearance >

The pavilion building is a single storey wrap-around to the existing sports centre. It will form the main access to formal facilities within the secure area of the site (AGPs and athletics enclosure). Subservient to the main Bede Sport Centre most of the elevation will be a buff facing brick, with glazed curtain walling to the draught lobby and ribbon windows to the café areas and community room providing views to the sports facilities beyond. Canopies and other preformed aluminium elements will be a rusty red to reference the panels on the existing sports centre.

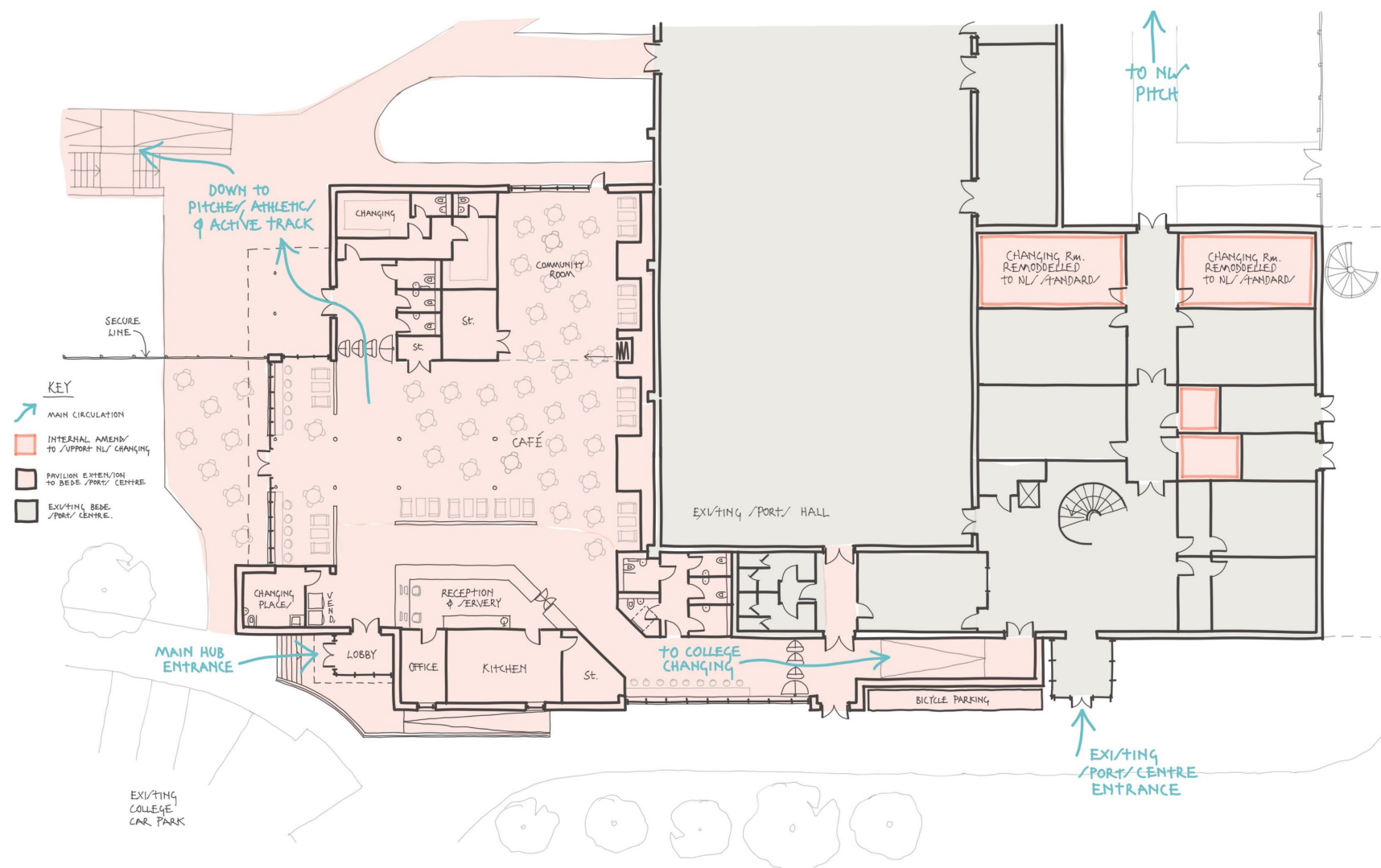

## < Accommodation

Briefly, the pavilion building comprises; main entrance with draught lobby accessed via ramp and stairs off the existing college car park; reception/server area with office, kitchen, and kitchen store; vending zone with a changing place provision behind; central café area subdivided into zones; external terrace area with covered seating and good connection with the existing college campus; dry change area with toilets beyond turnstile paywall; community room which can be partitioned off from main café and with dedicated storage; toilet block with accessible toilet and dedicated baby change; access corridor to wet change areas in existing sports centre. Some modest remodelling of the existing changing facilities within the existing sports centre is proposed to meet NLS needs.



# Example Images

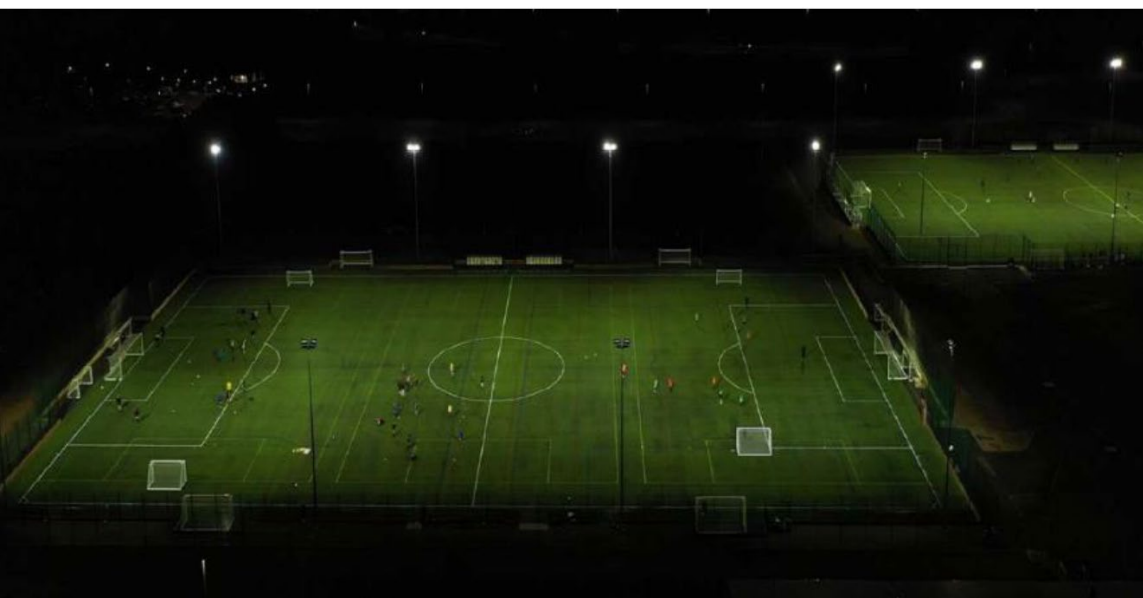

^ example of floodlight spill contained to pitch boundaries



^ example of active track layout



^ example of SuDS attenuation basin as part of sitewide drainage strategy

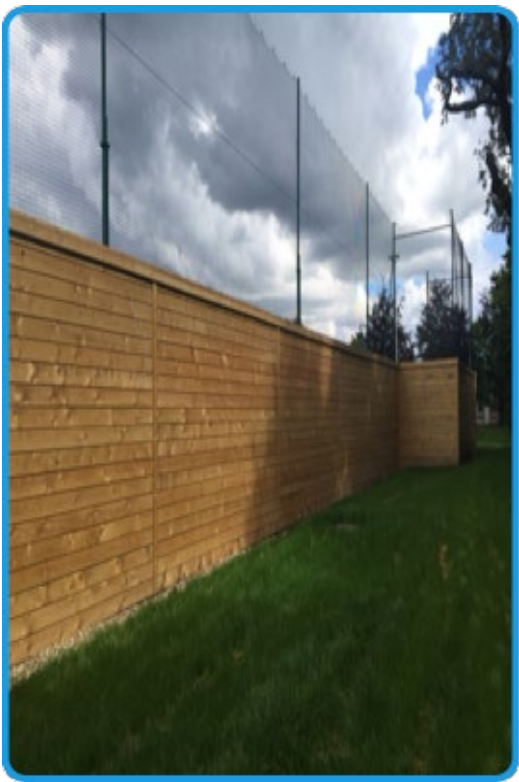

^ examples of acoustic quilting and fencing with ballstop fencing



^ example of detox grids and low-level trek boards to manage rubber crumb



# Frequently Asked Questions

## **Q. When is Billingham Sports Hub being developed?**

A. The proposal is being developed through the Football Foundations Hubs Programme. This public consultation is a key stage in understanding residents' views so any concerns can where possible be addressed prior to the submission of a planning application. It is the intention to submit formal funding applications later this year and if successful we hope delivery will begin in Spring 2025 and become operational in Spring 2026.

## **Q. How long will the Active Track be?**

A. One full lap of the active track has been designed to be 1km.

## **Q. Can I cycle on the Active Track?**

A. We envisage that the active track will support community use in a variety of ways, including wheelchair users, cycling, walking, jogging, etc.

## **Q. Will the playing fields and active track remain accessible to the public?**

A. The main public access for the playing fields and active track will be from Neasham Avenue.

## **Q. Will the public playing fields and active track be secure against antisocial behaviour?**

A. The boundary treatment of this publicly accessible area will be designed to limit and control access points. Motorised vehicular entry will be restricted through boundary treatments and chicanes, drop-bollards, and step-up stiles as appropriate. CCTV could also be explored.

## **Q. Will the playing field area be reduced?**

A. Legacy hardstanding from previous uses will be made into grassland to add to the overall playing field area and the provision of AGPs will support increased use.

## **Q. Will rubber crumb from the artificial pitches be harmful to the environment?**

A. Rubber crumb will be contained within the pitch areas using low level trek boards and detox grids at pitch entry points (see example images)

## **Q. Will the facility be open during the evenings?**

A. The football and athletics areas will operate in the evenings throughout the year, with floodlighting to the pitches when needed during shorter days. The active track will operate low level artificial lighting which will be incorporated within surfacing.

## **Q. Is there enough car parking to support the proposals?**

A. Circa 225 new car parking spaces are being proposed alongside the existing car parking spaces which are available at Bede Sixth Form College to meet demand generated through the proposals. A transport assessment will be submitted alongside the planning application.

## **Q. Will floodlighting impact local residents?**

A. Floodlights will incorporate integrated louvres to ensure light is contained to the playing boundaries. This is an extremely effective technique for minimising light pollution from sports pitches (see example image)

## **Q. Will noise from sports impact local residents?**

A. Where there is any chance of noise from the sports hub being detrimental to local amenity, acoustic fencing or other mitigation techniques will be employed (see example image). A noise impact assessment will be commissioned to determine this impacts and required mitigation.

## **Q. Will there be impacts on biodiversity and how will Biodiversity Net Gain be achieved?**

A. A detailed ecological assessment will be commissioned to ascertain any impacts. Proposals seek to retain existing ecology where possible and incorporate a combination of ecological ponds, swales, and new planted areas to ensure the project's biodiversity is in line with planning policy requirements..

## **Q. Parts of the site are within flood risk zones. How will this be managed?**

A. Sustainable Drainage Systems (SuDS) will be integral to the projects overall drainage strategy, ensuring that the required discharge rates are achieved. A flood risk assessment will be required as part of any planning application and proposals will ensure any flood risk implications are addressed. The majority of proposed development avoids flood risk zones..

## **Q. Use of rubber crumb infill on artificial pitches?**

A. Whilst under development there are currently no widely available alternative infill products with proven durability on the market that are as effective, suitable for all UK weather conditions and deliver the required performance standards. See the national joint statement and FAQ on the use of infill materials at <https://sapca.org.uk/guide/position-statement-on-3g-pitches/> for further information